

**Midwest Theater**  
**Scottsbluff Ne 69361**  
**Technical Specs Updated – Feb 2019**

The house sound system utilizes self-powered loudspeakers manufactured by Meyer Sound. Recognized as a pioneer in the field, Meyer products are frequently specified for Broadway, Concert Touring, and other sound reinforcement applications where sonic accuracy, fidelity, and reliability are required. The self-powered products offer numerous advantages over conventional loudspeakers, as the built-in signal processing and amplification is specifically tailored to a particular enclosure / transducer combination. In addition, the speaker components are protected from abuse by internal limiters that unlike external signal processing cannot be tampered with. The result is an extremely reliable, high quality system that will meet the needs of the facility for years to come. The sound system has been configured with house fronts, balcony and under balcony fills, and subwoofers.

**Live Shows**

2 self-powered loudspeakers (Meyer CQ Series) are placed next to the proscenium opening in a left / right configuration, along with 2 Meyer Subs (USW-1P). These speakers provide coverage for the main house seating areas, including the balcony and main floor, 2 fills are located under balcony, along with 4 more in balcony (Meyer MM-4).

**Cinema**

3 self-powered loudspeakers (Meyer CQ Series) are placed behind the screen in a left / center / right configuration, along with 2 Meyer Subs (USW-1P). These speakers provide coverage for the main house seating areas, including the balcony and main floor, 2 additional fills are located under balcony, along with 4 more in balcony (Meyer MM-4).

**House Mix / Processing**

A 64 Channel mixing console (**Yamaha QL5**) located in FOH has been provided for the house mix. The system is configured to provide equalization, limiting, summing, and delay functions. System connects to stage via Dante Snake. The system is also set up with quality playback components including Blu-ray, DVD and CD players.

**Lobby**

All sound in theater is sent to a Lobby System located in the Concession Supply Room. Local & Global Page Mics are also located there.

**Hearing Assistance System**

In order to comply with ADA requirements, a two-channel hearing assistance system has been installed. It includes the FM transmission components as well as 4 headset receivers, a battery charger, along with spare batteries. The assisted listening system allows 1 channel of audio to be broadcast throughout the facility.

**Clear-Com System**

- 1-Clearcom (MS-232) Two-Channel Main Station (located backstage at stage manager's panel)
- 1-Clearcom (KB-211) Speaker Station (in green room)

- 5-Clearcom (RS-601) single channel belt packs
- 5-Clearcom (CC-95) single muff headsets

There are belt pack stations at the following locations:

- |                            |                     |                   |
|----------------------------|---------------------|-------------------|
| 1- Stage Manager's Station | 1- Stage Left       | 1- Front of Stage |
| 1- FOH Position            | 1- Projection Booth | 1- Tech Booth     |

All Stations that Use Belt packs can be Daisy chained

**HOUSE SOUND REINFORCEMENT SYSTEM**

- 3- Meyer CQ Series Self Powered Loudspeaker
- 2- Meyer (USW-1P) Subwoofers
- 6- Meyer MM-4 Downfill (Mounted over and under Balcony)
- 8- EV Monitors (SxA100+)

**HOUSE MIX / PROCESSING**

- 1-Yamaha QL5
- 1 BSS Soundweb DSP (Model #9088)
- 1- Yamaha Dante Rio Stage Box 3224

**Microphone Inventory & other Audio equipment**

- 2- AKG Mic's Beta 58 type
- 4- Shure Beta 58
- 6- Shure UHFWR Wireless Handhelds w/58 Heads
- 2- Shure UHFWR Wireless Belt packs with Countyman Headset
- 2- 6 Channel Snakes 25ft
- 1- 12 Channel Snake 100ft
- 3- AKG (CK 31) Choral Mics
- 1-Drum Mic Kit
- 2- Shure Podium Mics

**ELECTRIC & LIGHTING**

Lighting Controls:  
Phillips/Strand Neo Console

**Hang Positions**

- |                                    |                                   |
|------------------------------------|-----------------------------------|
| House left front rail: 8 circuits  | House left back rail: 8 circuits  |
| House right front rail: 8 circuits | House right back rail: 8 circuits |
| Upstage Truss: 16 dim / 8 non-dim  | Upstage wall: 2 circuits          |
| FOH Truss: 16 dim / 8 non-dim      |                                   |

**Lighting Instrument Inventory** – Fixed Lighting Plot, inquire with theater manager about changing

- |                                 |                                |
|---------------------------------|--------------------------------|
| 20 - 30° Altman Shakespeare     | 16 - Altman 64 PARs            |
| 4 - Altman single cell sky cycs | 2- Lycian Zot 15HPi Spots      |
| 8- SL PAR 155 LED               | 18-PLPROFILE1 MKII LED 18°-34° |

**STAGE SPECIFICATIONS**

Painted (black) ply wood floor.  
Proscenium opening: 34'10"

Stage depth: 23'9"

Stage width: 35'

**Permanent installations:**

- Audio Rack & Stage Mangers Panel
- Loading door: 60" X 89"
- Loading door located at (46") above street level, Access is from alley. Permit to Block Alley Required from the City of Scottsbluff to be taken out @ least 24 hours before use
- Front-Stage, No Curtain
- Mid-Stage Black curtain – operates stage-right Splits Center Stage
- US Black Curtain – operates stage-left from Left to Right
- US White scrim – operates stage-left from Left to Right
- Retractable Movie screen located Mid-Stage behind Mid-Stage Black.

**Softgoods:**

- Hanging 13x7 Screen – Can be located as required

**Dressing Rooms**

1 - Star/Handicap Dressing room

12'4"X 13 – 2 Mirrored & Lighted Stations + restroom & shower

1<sup>st</sup> Floor – stage left

2 – Choral Style Dressing rooms

17'5" X 18 – 8 Mirrored & Lighted Stations + Restrooms & showers

By Green Room – 2<sup>nd</sup> floor – stage left

**Telephone & Internet Services**

Analog lines available, with direct dial to all Dressing rooms, plus FOH mix positions, by request. Wireless internet available, by request.

**Seating CAPACITIES**

729 + 3 Handicap Seating

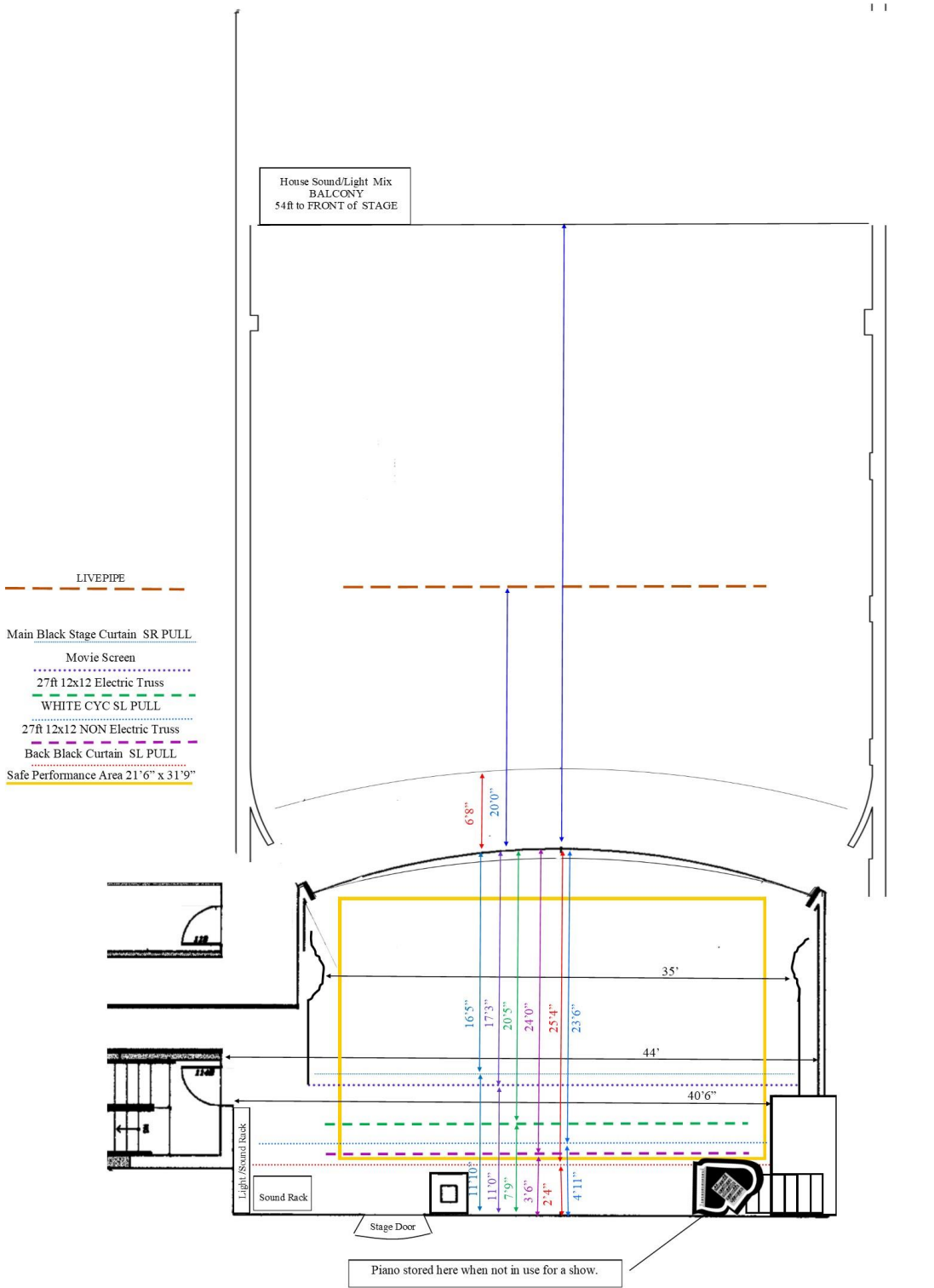

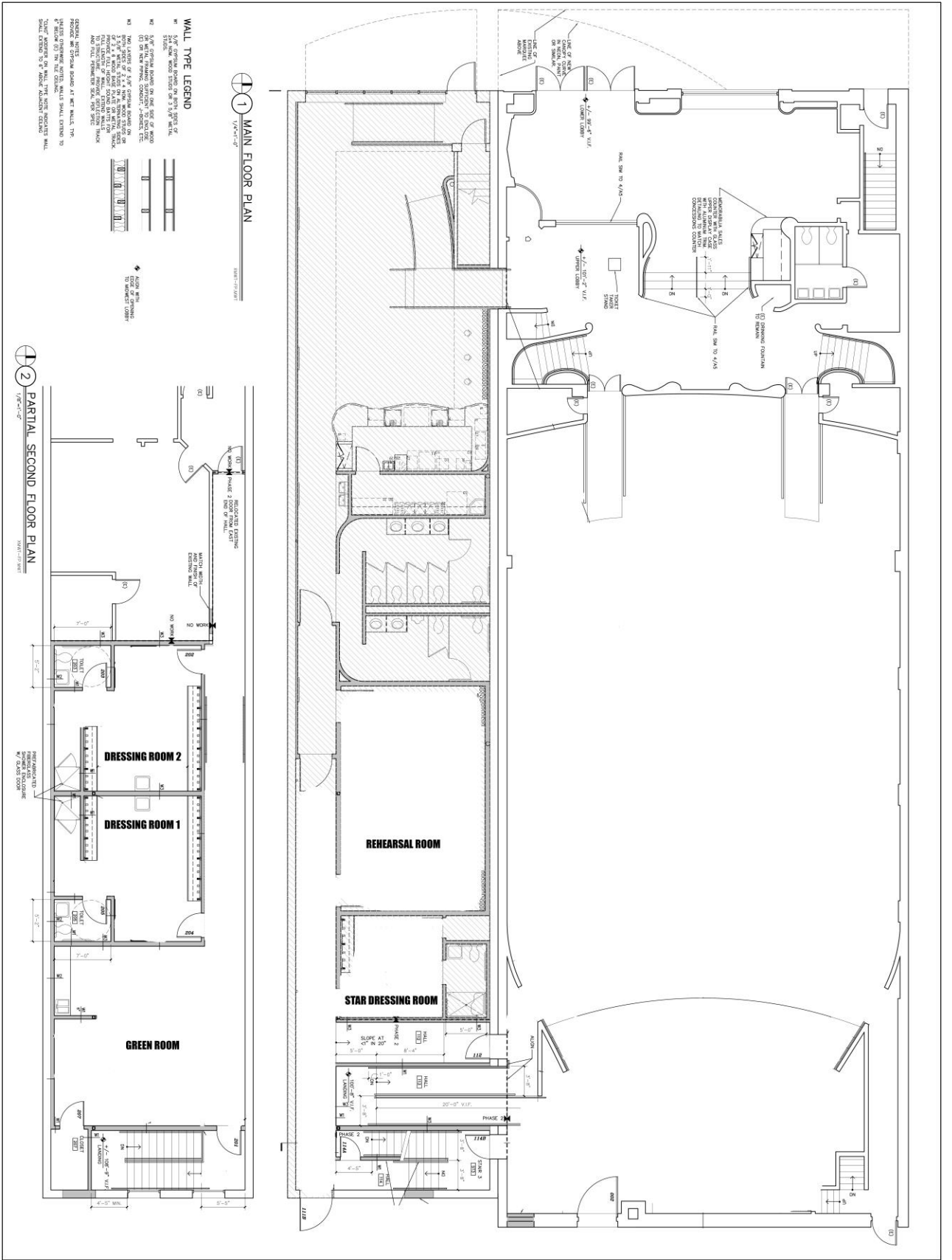

# Midwest Theater - Scottsbluff Nebraska - Seating Chart

